

## Karaoke microphone AT0010 - K3

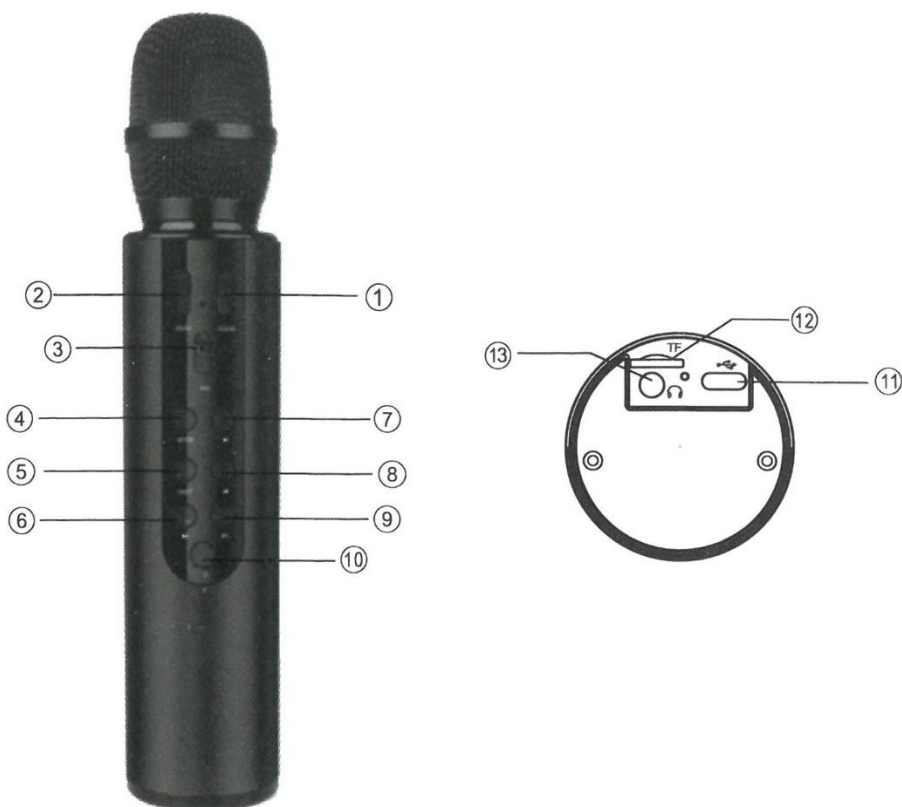

### Instructions for use

To enhance the performance you can get from this product, please read the instructions carefully before use. Please fully charge the battery before using the microphone for the first time.



1. ECHO +/- button
2. MUSIC +/- button 3.
3. Microphone volume +/-
4. Mode function
5. Duet singing
6. Play/Pause button
7. Next song button
8. Previous song button
9. Vocal reduction
10. ON/OFF button
11. Type-C Charging Port / Recording Port
12. TF card slot
13. Headphone output

## **Description of operation**

### **On/Off mode**

To switch on: press and hold the ON/OFF button for a few seconds.

To turn off: press and hold ON/OFF button for a few seconds

### **Play / pause**

Playing music: One touch of the Play/Pause button

Pause music: One touch of the Play/Pause button

### **Mode**

In Bluetooth mode (if there is a TF card in the card slot and the LINE IN audio cable is inserted), press the key twice successively to change the mode -> card reading -> LINE IN -> Bluetooth, and so on is changing.

### **Duet singing**

Two microphones can work at the same time, click the duet singing button of one of them, and search the microphone by Bluetooth. The indicator light of one of them will always be on when connecting to duet mode.

### **Next song**

Press "next song" while singing karaoke to switch to the next song.

### Previous song

Press “ previous ” while singing karaoke to change to the previous song.

### Reduce voice

Press “Reduce Voice” while singing to change the accompaniment of the original song.

### NOTE:

1. Please hold the center part of the karaoke microphone when using it. Do not hold the sound position of the speaker, to avoid low sound or high-pitched beep (feedback).
2. Do not place this product in humid environment or high temperature.
3. When the product emits a “tick” warning sound, it may mean that the power of the product is too low. Turn off the product and charge it in a timely manner. Do not use the product during the charging process, to avoid the background sound of electric current.
4. If you can not find the bluetooth, please make sure the speaker and cell phone are in a valid connection range and the speaker in Bluetooth searching mode, as well as the Bluetooth speakers are not paired with other phones.
5. If you cannot connect the Bluetooth, also check if there are other speakers connected to the cell phone. Delete unnecessary connection devices in time.
6. If the above steps do not solve the problem, please turn off the product for charging or turn off your phone and restart it, then try the above steps again.

### Power on/off operation

Press the power on/off key for 3 seconds to turn on the Bluetooth speaker, if the start indicator voice is emitted, that means the device has been turned on. After using the product, press the power on/off key for 3 seconds to close the Bluetooth speaker and the power off warning tone will be emitted.

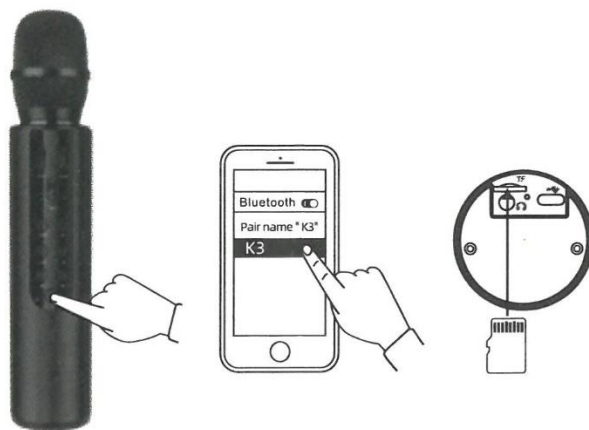

### Bluetooth music function

After turning on the speaker, the blue indicator light flashes rapidly, and the speaker enters the matching search status. At this point, turn on the Bluetooth function of the cell phone and

search for the device, when the name K3 appears, click to start searching. After the search is done, a warning tone will be heard, and then the cell phone player will be activated to play the song. If you want to sing without the original, press “reduce voices” to change the singing accompaniment.

### **TF card music function**

With the microphone on, insert the TF memory card into the TF card slot of the Bluetooth speaker (pay attention to the direction), a “beep” warning sound will be emitted, indicating that it has entered the TF card playback mode, and the speaker will play the songs on the TF card at this time.

Tip: when listening to songs in any Bluetooth microphone mode, in order to avoid microphone reverberation when playing songs, set the MIC volume to minimum, and songs can be played normally after opening the cell phone music player.

### **External speaker and headphones**

This microphone can be connected with headphones and speaker through the 3.5mm port. Easy to use, just connect it to the 3.5mm output port of the microphone.

### **Karaoke song recording**

#### **Bluetooth karaoke and recording**

Apple or Android cell phones can download karaoke applications, as well as other software to properly adjust the voice equalization, modulation and reverb effects to achieve the best sound mix. You can open the Karaoke software from the cell phone and click on the Karaoke accompaniment. After recording, you need to adjust the software accompaniment sound to minimum before saving and releasing, so as to avoid noise caused by repeated accompaniment. The bluetooth karaoke by default records the voice from the ambient sound to the microphone of the cell phone, which reduces the sound quality. In order to achieve the best recording result, please use the recording cable to implement direct line recording.

#### **Karaoke and recording using the recording cable.**

With the microphone turned on, connect the 3.5mm audio plug to the audio port of the cell phone, then insert the Type-c plug into the Type-c port at the bottom of the speaker, open the karaoke software of the cell phone, adjust the accompaniment volume of the cell phone player accordingly, and then record songs through the recording cable. To record with the audio cable, it is necessary to disconnect or turn off the Bluetooth of the cell phone.

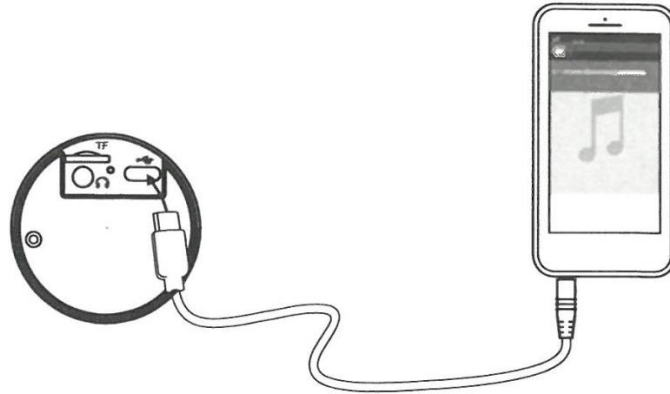

## Charge

Insert the USB cable into a standard USB power adapter (5V1A), and the Typo-C connector of the charging cable into the charging port of the device. The red indicator light on the left side of the charging port indicates that the product is starting to charge, and the red indicator light off indicates that charging is complete.

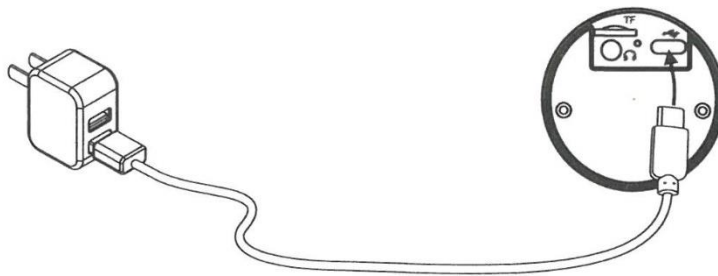

## Product specifications

Pickup: Capacitive type.

Reverb mode: Reverb effect.

TF card playback format: Mp3, wma, wav.

Transmission distance: <10 m (barrier-free distance).

Operating frequency: 2.402 - 2.480ghz.

Transmission power: 4dB.

Receive sensitivity: - 85dB.

Signal to noise ratio:  $\geq 80$ dB.

Distortion:  $\leq 1\%$  - 2%.

Output power: 5W+5W.

Speaker specifications: 40mm 4 Ohm / 5W.

Frequency response: 30Hz-20KHz.

Charging power supply: 5V = 1A.

Charging time: approximately 4 hours.

Product size: 245 x 50 mm.

Net product weight: 350g.

Audio input: Bluetooth / TF / aux connection.